

M4

121

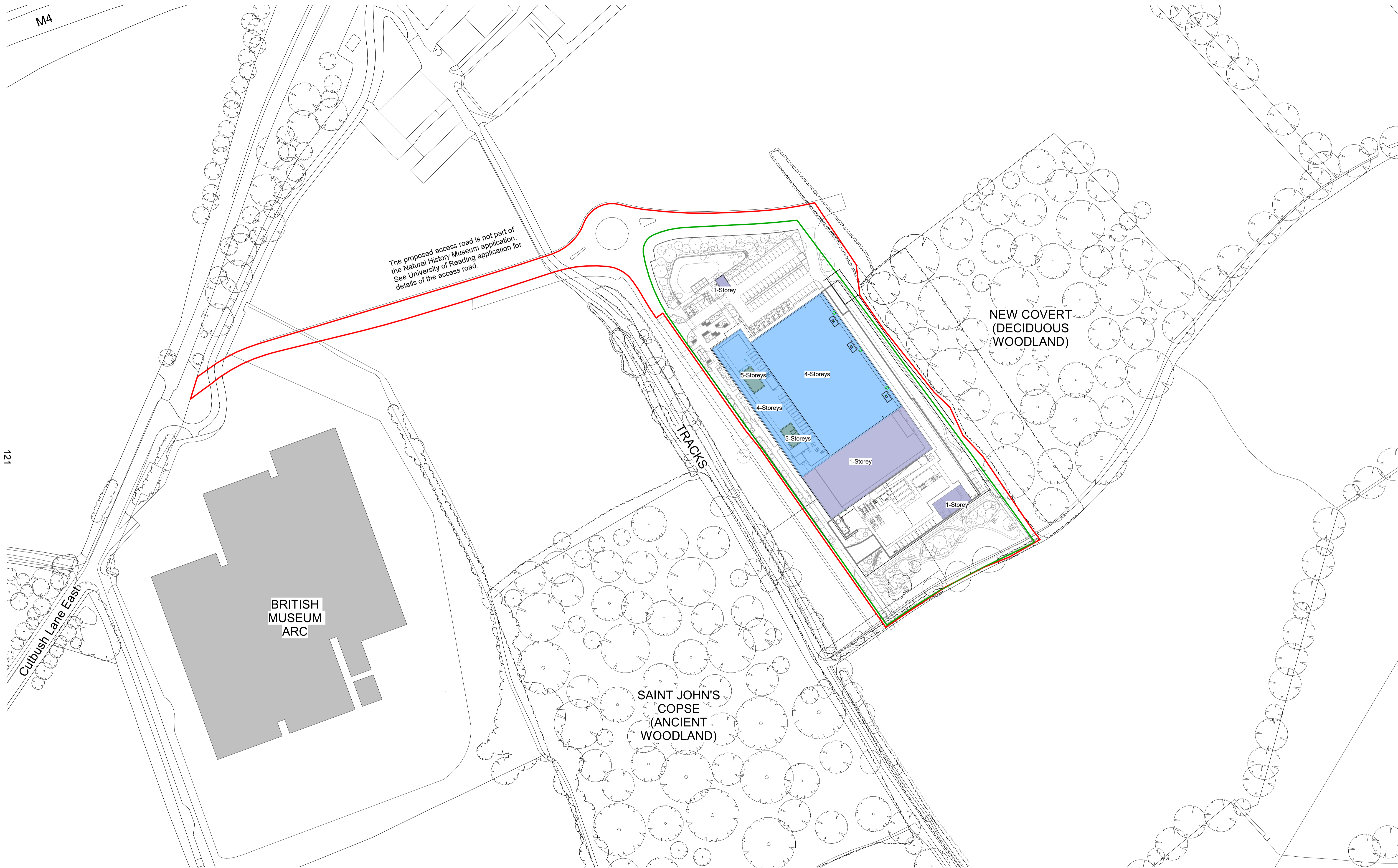

1 Proposed Site Plan
1 : 1000

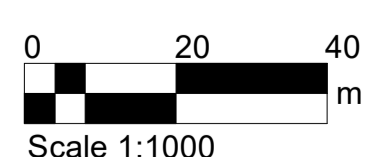

General Note:
Dimensions are not to be scaled from this drawing. All discrepancies in this drawing are to be reported to Feilden Clegg Bradley Studios.
Drawing only to be used for the purposes it was issued for. Do not modify any element of this CAD drawing. Landscape, public realm and neighbouring buildings shown indicatively. This drawing is copyright.

SITE KEY
— Development Boundary
— Planning Application Boundary

Note: OS Map augmented with information received from University of Reading.
OS Licence: 100007514

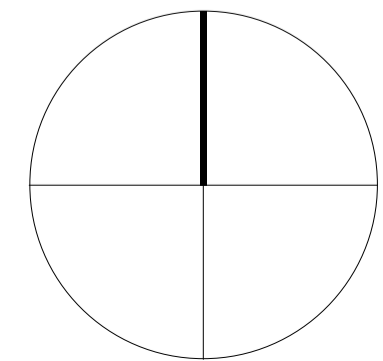

FeildenCleggBradleyStudios
LLP

London Office
Tottenham Street
London
W1T 4RG

t +44 20 7323 5737
e london@fcbstudios.com

Rev	Status
P01	S5 Issued for Planning Application

Date
15/11/2023

SUITABLE FOR PLANNING

Job/Drawing No
RD001-FCB-XX-RF-DR-A-0102

NHM Unlocked, Thames Valley Science Park
Proposed Site Plan

Revision
P01
Status
S5

Scale As indicated@A1
Date October 2023
Do not scale

Drawn Group JC
Checked Checker
All dimensions to be checked on site

FCBS project no RD001

This page is intentionally left blank